

### MODEL B

Newest, most advanced FOUNTAIN STENCIL ROLLER for all types of Stenciling.

- Instant pump action ink feed.
- Press button adjustable for left or right hand use.
- Long wearing O-ring seals throughout.

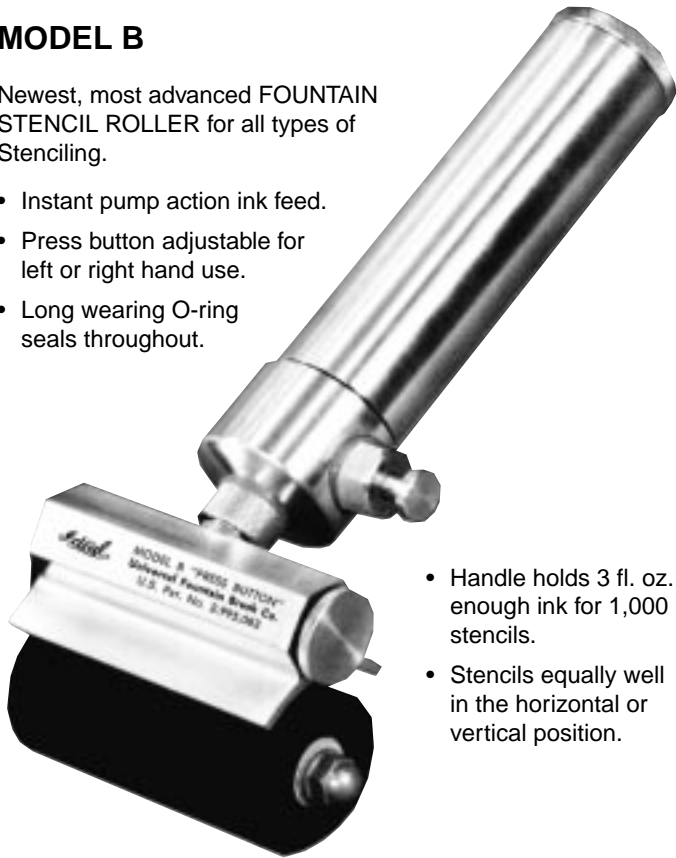

- Handle holds 3 fl. oz., enough ink for 1,000 stencils.
- Stencils equally well in the horizontal or vertical position.

### ROLL-A-STENCIL JR.

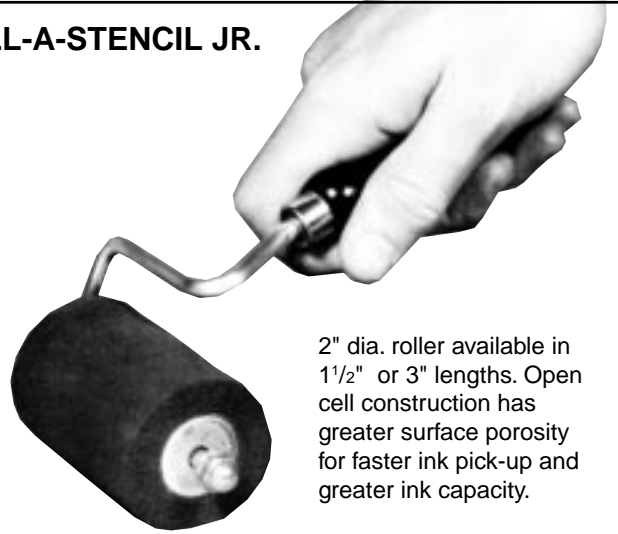

2" dia. roller available in 1 1/2" or 3" lengths. Open cell construction has greater surface porosity for faster ink pick-up and greater ink capacity.

ROLL-A-STENCIL JR. handles those alcohol base inks for porous and non-porous surfaces with ease. Just pour the ink on the pad ... and roll the "Jr." applicator over it a few times. The special porous surface of the roller picks up the ink, storing enough for 50 or more stenciled impressions. Roller cover supplied keeps roller from drying out between jobs when not in use. Comfortable offset handle makes it easier to stencil and keeps the roller off the surface when you lay the unit down. If you want a fast means of stenciling any type of surface and a fool-proof easy to use system, you will like this one.

### PARTS LIST

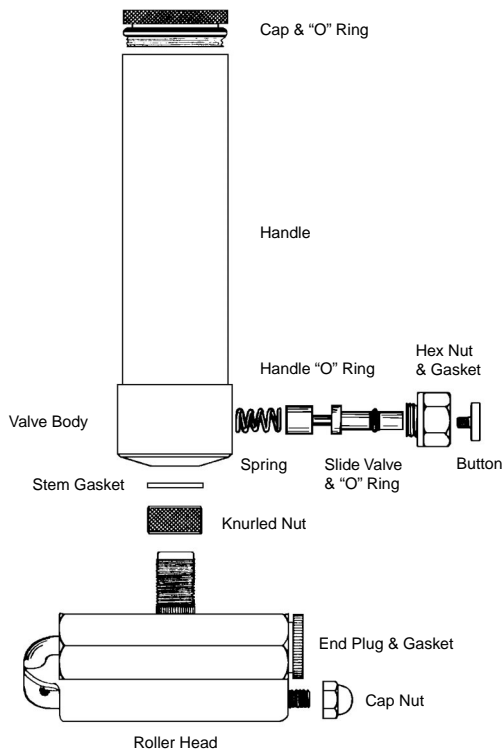

### IDEAL MODEL B "PRESS BUTTON"

#### Directions

1. Use #714 Stencil Ink for all porous surfaces.
2. Use #716 Stencil Ink for non-porous surfaces - metal, painted drums, etc.
3. Remove knurled filler cap and pour ink in barrel up to 1/2" of top. Replace filler cap.
4. Hold applicator horizontally and press the button, several times at first, to break in a new roller, then roll over newspaper to ink the roller evenly. You are now ready to stencil. When roller needs more ink, press the button once and release the button promptly.
5. When stenciling on the sides of a container (vertical position) have roller inked as in (4) above. Don't press the button in this position as ink will only flow to the lower end of the roller.
6. The Press Button can be positioned on the top of other side if desired by loosening the knurled lock nut and rotating the handle to the desired position.
7. All parts are removable for cleaning or replacement and no tools are needed.
8. Keep protective cover over roller during idle periods to prevent drying out.
9. It is important to change the felt wick at least each time rubber roller is replaced, preferably more often. This will improve ink feed and roller will last longer.